

R.W.M.A. Class II Alloy

## TAPER NOSE SHANKS

PART NUMBER		"A" SHANK LENGTH	USE WITH INSERTS
No. 1 MORSE TAPER	No. 2 MORSE TAPER		
2114 2120 2124	2214 2220 2224	1½ 2 2½	Series "O" Page 11
2130 2134 2140	2230 2234 2240	3 3½ 4	

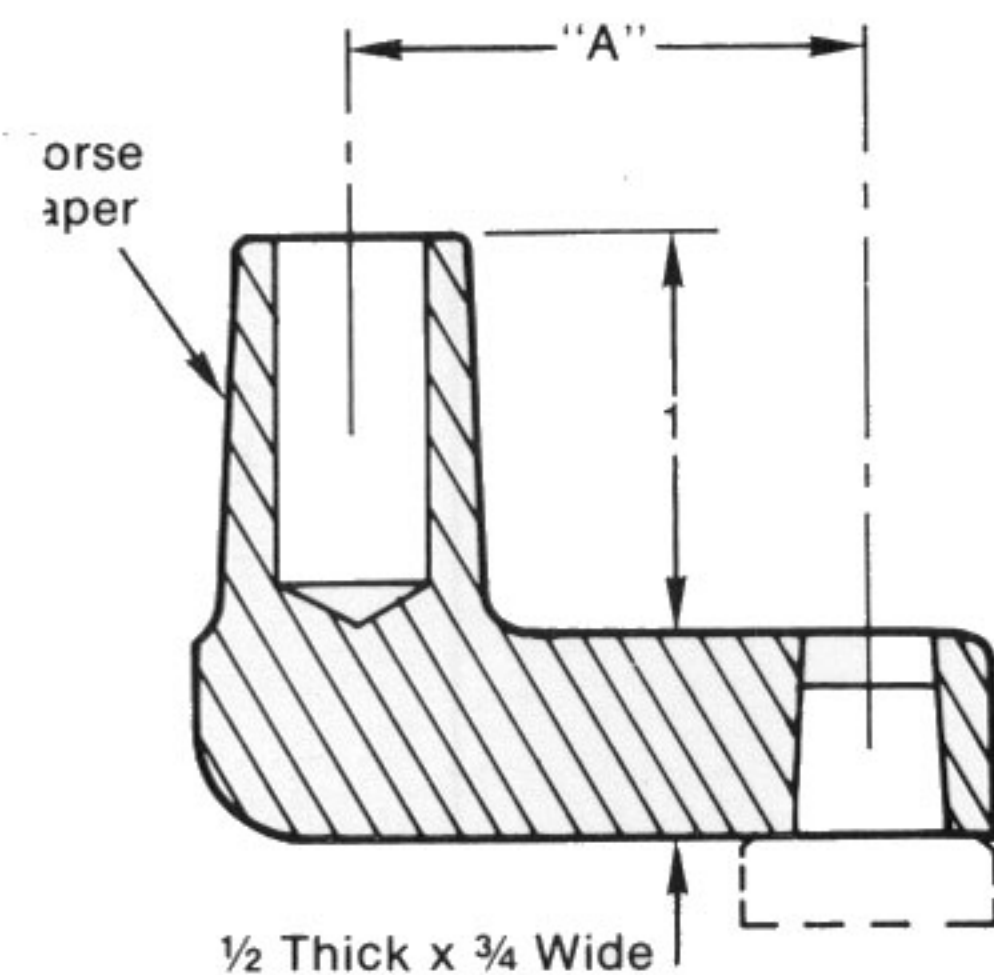

R.W.M.A. Class II Forging

## OFFSET FORGED SHANKS

PART NUMBER		"A" OFFSET	USE WITH INSERTS
No. 1 MORSE TAPER	No. 2 MORSE TAPER		
OSF-10 OSF-11 OSF-12	OSF-20 OSF-21 OSF-22	1¼ 1¼ 1¼	Series "O" Page 11 Series "I" Page 12 Series "2" Page 13

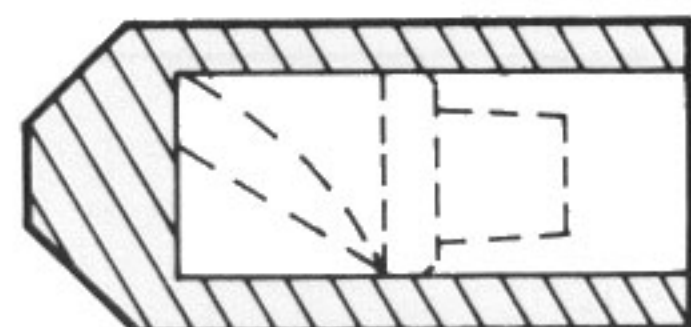

For Mating Offset Inserts Into Shanks  
Straight Without Damage To Taper

## INJECTOR PUNCH

PART NUMBER	USE WITH INSERTS
OP-1	Series "I" Page 12
OP-2	Series "2" Page 13